



GENERAL FEATURES

- Rack size **66x81,5 cm**
- Gross weight: 231 Kg
- Wash cycles/racks per hour: 2'-3'-6'-9'/30-20-10-7
- Stainless steel wash/rinse arms easily removable
- Wash pump: 2,3 kW
- Boiler capacity: 11 liters
- Tank capacity: 65 liters
- Boiler heating element: 6 kW
- Tank heating element: 6 kW
- Water quantity per cycle: 3,5 liters
- Useful washing height: 650 mm
- Electronic management with color LCD display showing boiler and tank temperatures, multicolored start button and self-diagnostic system
- ES System: energy-saving device that recovers the steam produced inside the machine to heat the incoming cold water
- PRS System: built-in atmospheric boiler, independent from the water supply pressure, with rinse pump to guarantee constant rinse temperature and pressure throughout the entire rinse phase
- High efficiency air gap (A class)
- Double electric detergent and rinse-aid dispenser
- Thermostop function (hot rinse)
- Green Function for energy saving
- Automatic end-of-day self-cleaning of wash tank
- Vertical self-cleaning washing pump

FILTRATION

- Pre-filtering of the tank water by means of stainless-steel filter equipped with collection basket
- Stainless-steel pump filter, easily removable

BODY

- AISI 304 stainless-steel body
- Double skinned insulated body
- Preformed wash tank in stainless-steel AISI 316 with rounded corners to avoid grime build-up
- Stainless-steel door handle
- Boiler in stainless-steel AISI 316

EQUIPMENT

- 1 stainless-steel rack 56.5x69 cm with wheels
- 1 inlet hose (2 mt length)
- 1 drain hose (2 mt length)

OPTIONS

- HD version (14,3 kW, in 380-415V 3N ~)
- Drain pump (DP)
- Chemicals level sensors (CLS)
- Wi-Fi connection (WIFI)
- 60 Hz version

ACCESSORIES FOR WATER TREATMENT

- External water softener

ACCESSORIES

- Stainless-steel special tray holders

WATER SUPPLY CONNECTION

- **Water supply hardness:**
Water hardness between 0 and 14°f (0 ÷ 8°d)
Above 14°f (8°d) suggested water softener
- **Water supply dynamic pressure:**
Standard between 1 and 5 BAR
- **Water supply temperature:**
Standard between 10 and 25°C

MAIN POWER SUPPLY

- The voltage of main power supply must be compatible with the rated voltage
- The machine must be connected to a suitable earth (ground) system
- Connect the machine power socket to the multi-pole wall switch provided

TECHNICAL SPECIFICATIONS

- Electrical supply: **380-415V 3N / 220-240V3~50Hz**
380-415V 3 (MULTIPOWER)
- Total power: **8,3 kW (14,3 kW in HD)**
- Absorbed current: **12 A / 21 A (21 A in HD)**
- Power cord supply size: **5 x 4 mm²**

AU 65.65 EPI ES

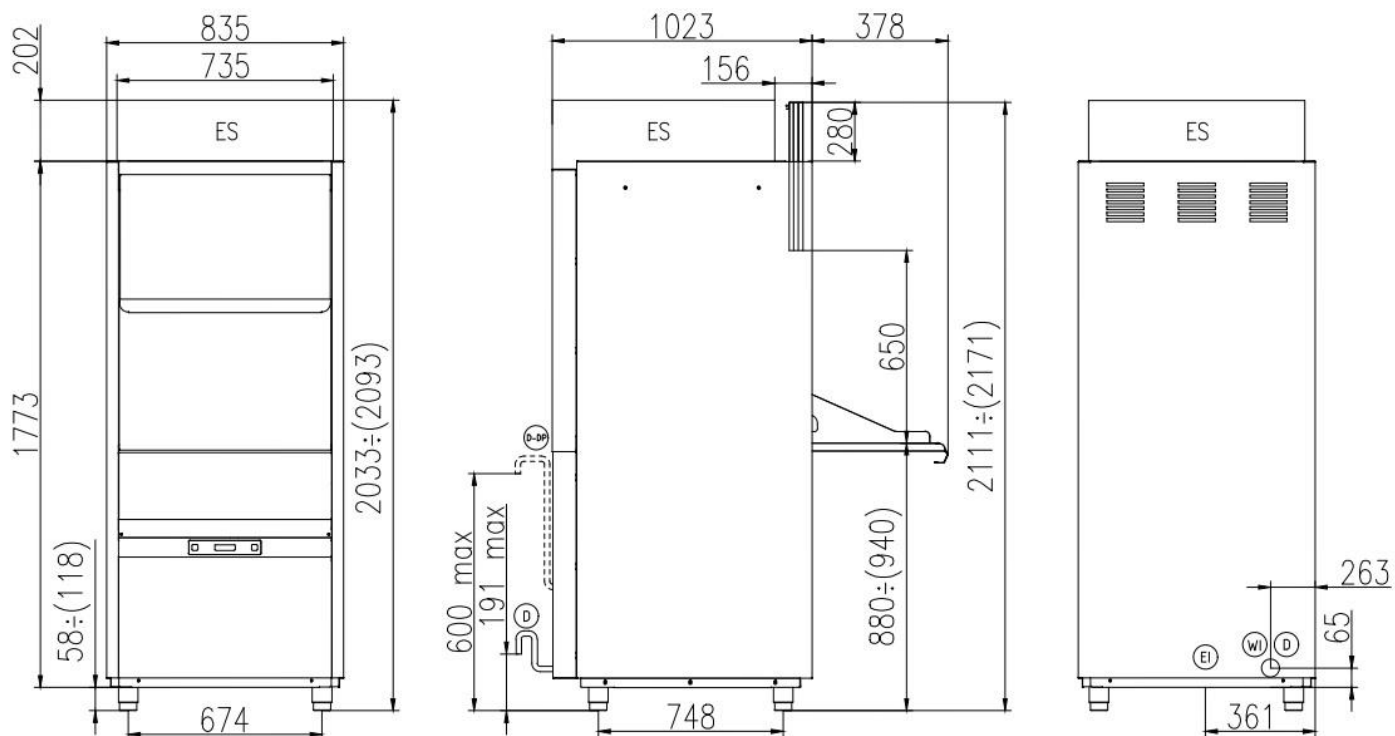

EI
 CAVO DI ALIMENTAZIONE
 POWER CORD SUPPLY
 CABLE D'ALIMENTACION
 CABLE DE ALIMENTACION

WI
 CANNA DI CARICO G 3/4 L=2000 mm
 G 3/4 INLET HOSE L=2000 mm
 TUYAU D'ALIMENTATION G 3/4" L=2000 mm
 TUBO DE ALIMENTACION G 3/4" L=2000 mm

D
 TUBO DI SCARICO ϕ 40 mm L=2000 mm
 DRAIN HOSE ϕ 40 mm L=2000 mm
 TUYAU DE VIDANGE ϕ 40 mm L=2000 mm
 TUBO DE DESAGUE ϕ 40 mm L=2000 mm

D-DP
 TUBO DI SCARICO ϕ 29 mm L=2500 mm (CON POMPA SCARICO)
 DRAIN HOSE ϕ 29 mm L=2500 mm (WITH DRAIN PUMP)
 TUYAU DE VIDANGE ϕ 29 mm L=2500 mm (AVEC POMPE DE VIDANGE)
 TUBO DE DESAGUE ϕ 29 mm L=2500 mm (CON POMPA DE DESAGUE)

	Min 10°C-MAX 60°C Min 10°C-MAX 25°C with energy recovery and water softener
	200÷500kPa(2÷5 Bar) 100÷500kPa(1÷5 Bar) with atmospheric boiler
	HARDNESS 5÷14f-2.8÷8'd